

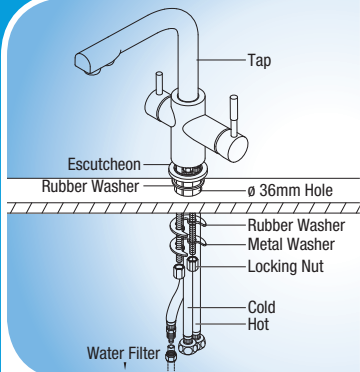

3M Water Tri-Flo – Easy 8 Step installation

If your water pressure exceeds 125 psi (862kPa) you must install a pressure limiting valve.
If you're unsure contact your plumbing professional.

1A



Assemble Tri-Flo tap through your sink faucet hole as shown.

1B

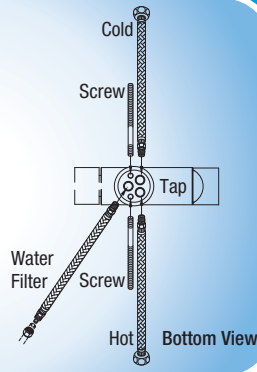

2



Select and mark a location under the sink that allows access for filter change, and attach filter head assembly to wall.

3

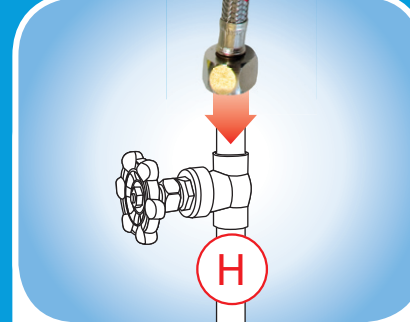

Connect the Hot water braided hose to the Hot water supply (take care not to over tighten).

4

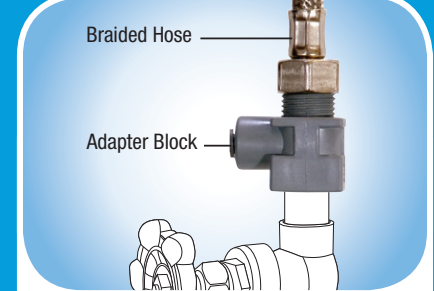

Connect the water filter adapter fitting to the cold water supply (take care not to over tighten). Then connect the cold water braided hose to the adapter block.

5

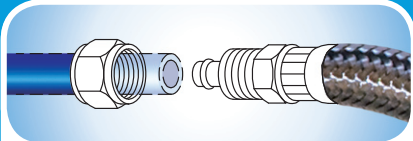

Cut a small piece of tube off of the coil provided to connect from the braided hose to the filter head outlet and ensure that the left over tubing is long enough to reach from the adapter block to the inlet on the filter head.

Connect the water filter tube, to the filtered water braided hose by assembling the compression fittings as shown.

6



Connect the other end of the tube to the outlet fitting on the filter head.

7

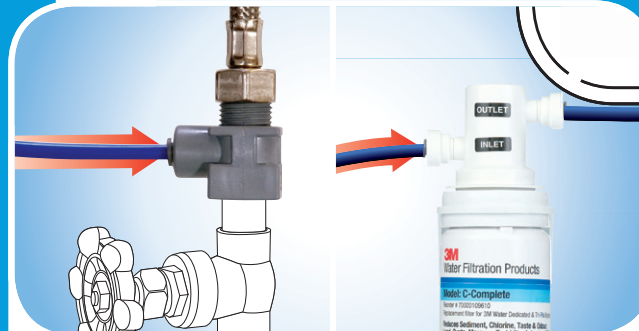

Insert the other length of tube from the adapter fitting on the cold water supply to the inlet of the filter head.

8

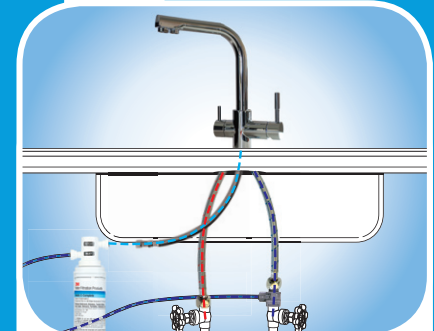

Turn back on water supply, check for leaks, then flush filter (run for 5 mins).