



3M Water Full-Flo – Easy 5 Step installation

*If your water pressure exceeds 125 psi (862kPa) you must install a pressure limiting valve.
If you're unsure contact your plumbing professional.*

1



Select and mark a location under the sink that allows access for filter change, and attach filter head assembly to wall.

2

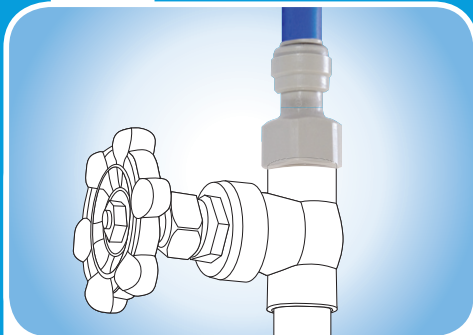

Disconnect existing cold water braided hose and replace with the grey water supply female adaptor.

3



Connect disconnected cold water braided hose to the white male adaptor fitting (a). Insert filter into filter head (b).

4

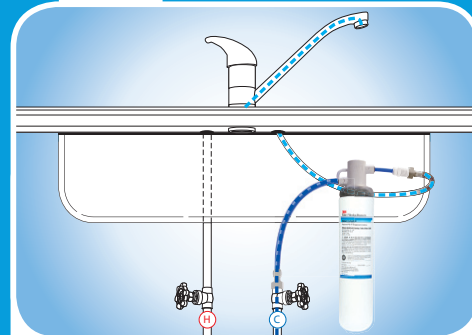

Turn back on water supply, check for leaks, then flush filter (run for 5 mins).

Comprehensive installation instructions – Online warranty – Online automated filter reminder service

www.3mwater.co.nz